

LEVER ACTION PUMP ADBLUE® INSTRUCTIONS AND PRECAUTIONS

CM0500

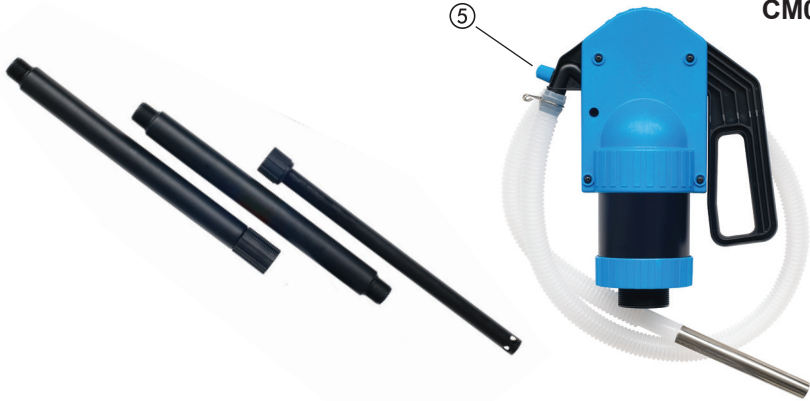

**PLEASE SAVE THESE INSTRUCTIONS.
READ ALL PRECAUTIONS AND INSTRUCTIONS CAREFULLY.**

SPECIFICATIONS

Item / Model	Manual Lever Pump / C M O 5 0 0
Delivery Volum	About 500cc per Stroke
Applicable Liquids	AdBlue®, Water, Lubricants, Windshield Washer Fluid, Antifreeze, Mild detergents, Agricultural chemicals etc.
Applicable range of Temperature	About -5°C ~ +45°C
Main Material	Polypropylene, Polyethylene, Viton /FKM

OPERATING INSTRUCTIONS

① How to assemble the Suction Pipes

1. Thread Suction Pipe B into Suction Pipe A (Diagram 1-①).
2. Thread Suction Pipe A+B into Suction Thread Hole (Diagram 1-②).
3. Adjust the length of Suction Pipe C to fit it with the height of the Drum and fix pipes B+C with Joint Nut (Diagram 1-③).

- Length of Assembled Suction Pipes:
- Suction Pipes (A+B+C) 980-1200mm
 - Suction Pipes (B+C) 620-840mm.

Note: The Suction Pipes fits a 200L Drum as well as a 1000L IBC Tank.

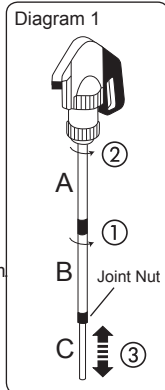

② How to operate the Pump

1. Insert the Suction Pipes into the Drum Can and fix the Pump Head with a Drum Bung Adaptor (Diagram 2-①).
2. Place the Pump Head in the appropriate position and fix the Pump Head firmly with the Lock Nut (Diagram 2-②).
3. Insert the Discharge Hose into the Outlet Spout and fasten it with a Clip (Diagram 2-③).
4. Stroke the Handle up and down rapidly until liquid starts pouring. Be careful not to spill the liquid on the ground when pumping the liquid into the receiving tank (Diagram 2-④).
5. Turn the Air Vent Cap counter-clockwise to stop siphoning (Picture above ⑤).

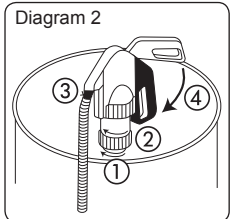

⚠ CAUTION

Do NOT use one Pump for more than one type of liquid.

- Operate the Handle smoothly to prevent the Pump Head from getting damaged.
- Do not place the Pump Head upside down, which would cause the remaining liquid to leak out of the Discharge Hose.